



SISMA

G. GIOANOLA

METERING EFFICIENCY

OBLO' plus

REMOVABLE DESIGN WATER METER
BUILT-IN SUPER DRY
360° ROTATING COUNTER
DRY DIAL



M-Bus wireless OMS®

OBLO' superplus

- ❖ Built-in system with SUPERDRY single jet meter
- ❖ DRY dial for turbid and very calcareous water, clockwork adjustable at 360°C
- ❖ OBLO' plus model DN 15 Q₃ 2,5, built-in box with threads 1/2" M, temp. class T90, measuring range starting from R80
- ❖ OBLO' plus model DN 15 Q₃ 2,5, built-in box with threads 3/4" F, temp. class T90, measuring range starting from R80
- ❖ OBLO' superplus model DN 15 Q₃ 2,5 built-in box with threads 1/2" M, temp. class T90, with Wireless M-Bus radio module, measuring range starting from R80
- ❖ OBLO' superplus model DN 15 Q₃ 2,5 built-in box with threads 3/4" F, temp. class T90, with Wireless M-Bus radio module, measuring range starting from R80
- ❖ The meter inside the system can be removed even after built-in installation
- ❖ It is proposed as an elegant piece of furniture for bathroom and kitchen and brilliantly solves the aesthetic problem of normal meters; the system is fitted with rosette and finishing cap, plastic box complete with fittings, plastic protective cover and holding extension for easy installation
- ❖ **U0-D0**: straight pipe not required upstream or downstream of meter
- ❖ All models are **MID** approved according to the European Directive **2014/32/EU** (module B+D) and in compliance with the norms **ISO 4064**, **EN 14154** and **OIML R49**
- ❖ Certified for use with potable water according to Ministerial Decree 174.

OBLO' *plus - superplus*

DN size mm – inches of meter only			15 - 1/2
Q ₃	Permanent flow rate	m ³ /h	2,5
Q ₄	Maximum flow rate for short period	m ³ /h	3,125
Q ₂	Transitional flow rate with measuring range R80H [MPE ±2%]	l/h	50
Q ₁	Minimum flow rate with measuring range R80H [MPE ±5%]	l/h	31,25
S	Accuracy at measuring range R80H	l/h	7
	Accuracy class		2
ΔP	Pressure loss class	bar	0,63
MAP	Maximum allowed working pressure	bar	16
	Dial register from/to	m ³	0,0001 / 100.000
	Weight of kit made by meter, rosette, cover	kg	0,600
	Weight full built-in box 1/2" M	kg	0,650
	Weight full built-in box 3/4" F	kg	0,700

MODELS:

Temperature class T90

OBLO' *plus*/15 Q₃ 2,5 - connections 1/2" M

OBLO' *plus*/15 Q₃ 2,5 - connections 3/4" F

MODELS:

Temperature class T90

OBLO' *superplus*/15 Q₃ 2,5 - connections 1/2" - with Wireless M-Bus radio module 

OBLO' *superplus*/15 Q₃ 2,5 - connections 3/4" - with Wireless M-Bus radio module 

CONNECTIONS G1/2" M

CONNECTIONS G3/4" F

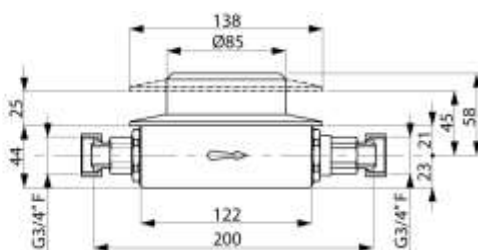
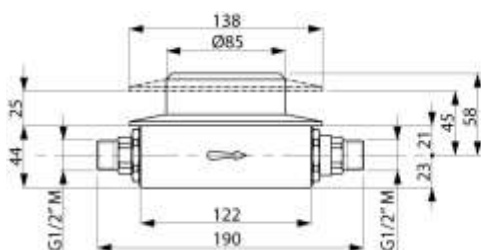

The company's policy is one of continuous product improvement and the right is reserved to modify the specifications contained herein without notice. Illustrations are not binding. 02-25

The internal counter, even after installation, is easily accessible and separable from the recessed box: in the event of a breakdown, it is easy to replace it with considerable time savings, avoiding the need to break the wall and the tiles.

The 360° adjustable counter on the SUPER DRY meter allows installation in any direction of the water flow (top, bottom, right or left).

The unit is equipped with a sliding rose on the bonnet to adapt to different mounting depths. **The maximum recess depth of the box is 45 mm from plaster to the center of the tube or 68 mm from the plaster to the back of the cassette (subtract from these measurements the thickness of the wall covering, if any).**

AVAILABLE OPTIONS

- Available, on request, prolonged chrome-plated cap to increase the maximum installation depth of a further 20 mm.
- All models can be supplied prepared or complete with radio module for remote reading with W-Mbus OMS protocol for walk-by/drive-by, and/or with LoRaWAN TM protocol for fixed network with 868Mhz frequency, and NB-IoT protocol.
- All models can be supplied with inductive sensor complete with radio module



TYPICAL ERROR CURVE

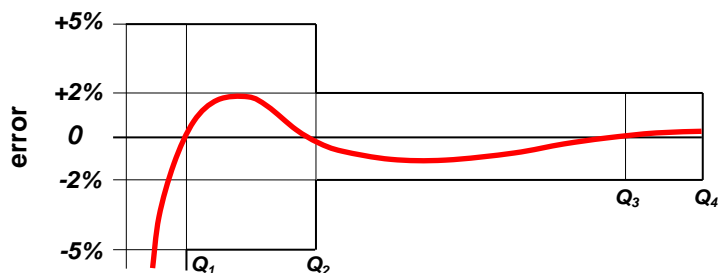

HEAD LOSS DIAGRAM

